

USER GUIDE

SMOKING SHELTER

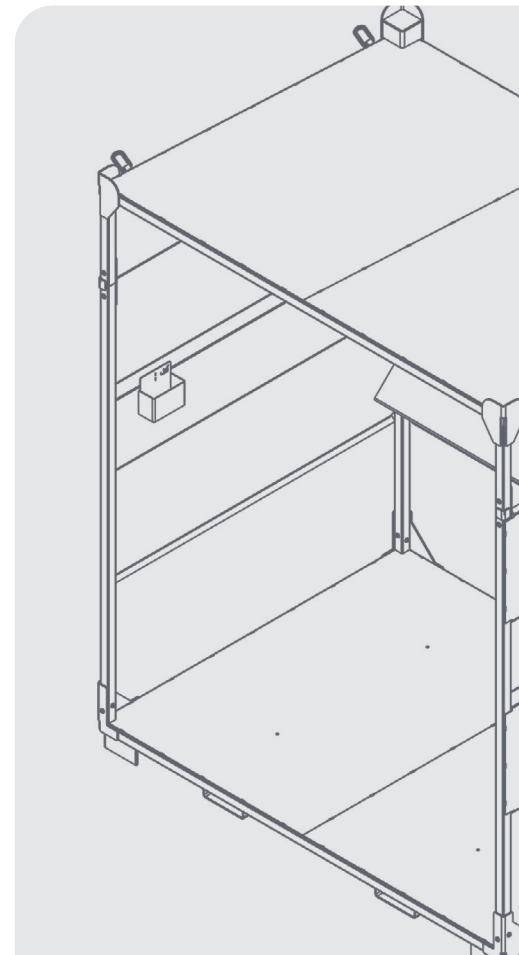

DISCLAIMER

Do not attempt to handle or operate this equipment before you have received sufficient training. It is imperative that you have read the General Safety Instructions on page 16 and sufficiently familiarised yourself with the Operational Procedures in this document.

Note that this item is compliant only to the standards specified in this User Guide and it is therefore the duty of the responsible person(s) to review and ensure compliance.

CONTENTS

PRODUCT INFORMATION

INTRODUCTION	04
SPECIFICATION	05
PARTS DIAGRAM	08

USAGE

GENERAL GUIDANCE	10
STORAGE INSTRUCTIONS	10
TRANSPORT & HANDLING	11
OPERATIONAL PROCEDURES	11
IMPORTANT USAGE NOTES	12
ASSEMBLY INSTRUCTIONS	13

SAFETY

GENERAL SAFETY INSTRUCTIONS	16
-----------------------------	----

LEGAL

TERMS AND CONDITIONS	18
EC DECLARATION OF CONFORMITY	22
STANDARDS AND REGULATIONS APPLICABLE	23

INTRODUCTION

OVERVIEW

The Conquip Smoking Shelter is a steel framework that provides shelter from bad weather for site workers to smoke in an outdoor, designated, safe environment.

Robust and weatherproof, the unit features a removable ashtray, that can be quickly and easily emptied, and a bench rest for extra comfort during cigarette breaks.

The unit can be preassembled by Conquip prior to delivery to site or it can be easily assembled on-site with suitable lifting apparatus.

The Smoking Shelter can be disassembled and 'flat-packed' when it is not in use, ensuring a minimal footprint when being stored on-site or when it is being transported.

KEY BENEFITS

- Partial steel sides and open front provide ventilation.
- Solid steel floor prevents precipitation ingress and ensures the shelter can be placed on most surfaces.
- Complete with a removable mounted ashtray and a bench rest.
- Multiple fork pockets and crane lifting points allow for easy transportation around site, as well as loading and unloading it from a delivery vehicle.
- The Smoking Shelter can be flat-packed and multiple units can be stacked on top of each other, providing space-saving benefits for storage and transport.

SPECIFICATION

SMOKING SHELTER

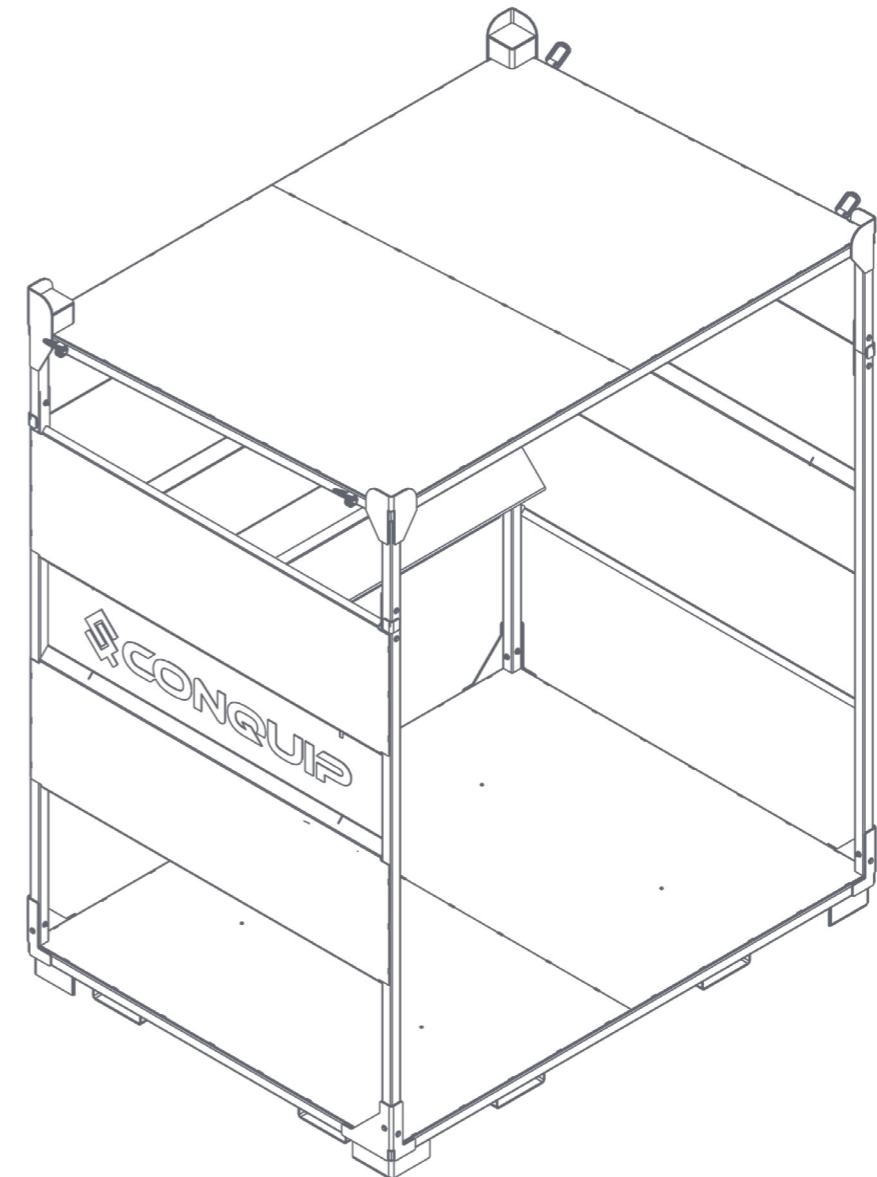

CODE	WEIGHT (Kg)
SS901AD-07200	368

SPECIFICATION

ASSEMBLED

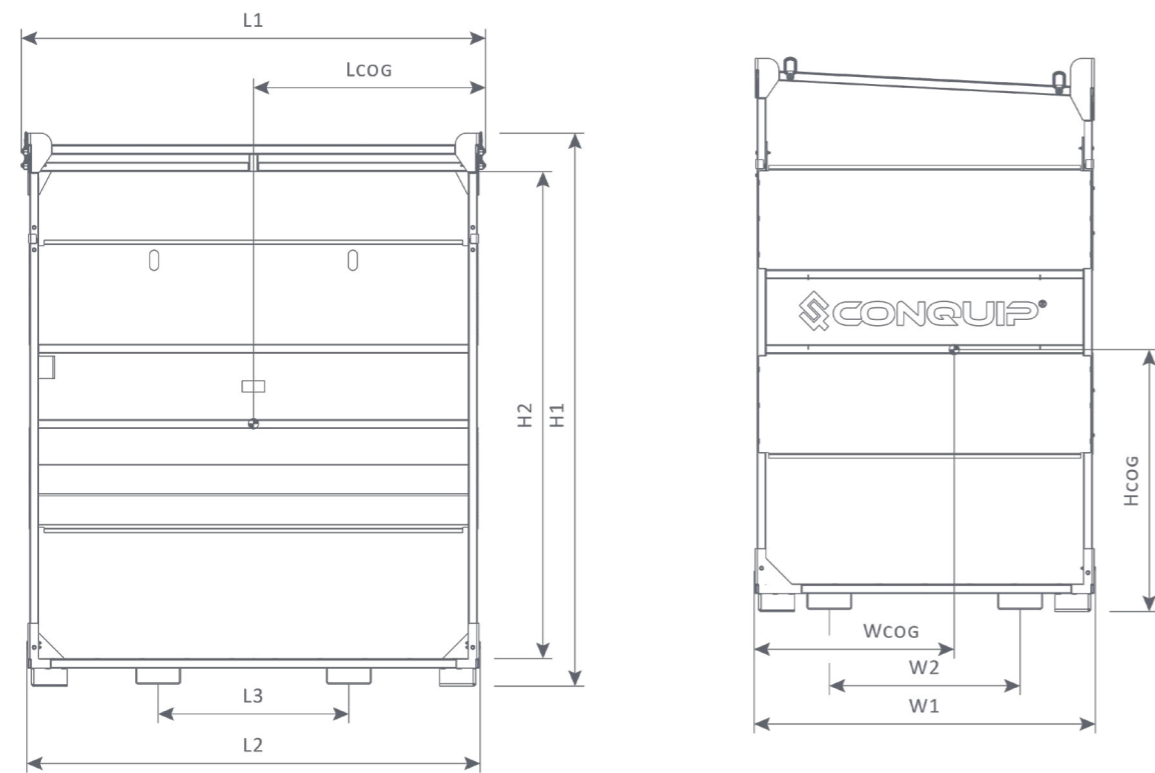

L1	L2	L3	LCOG	W1	W2	WCOG	H1	H2	HCOG
2070	2020	850	1037	1520	850	903	2465	2170	1156

All dimensions are measured in mm.

SPECIFICATION

FLAT-PACKED

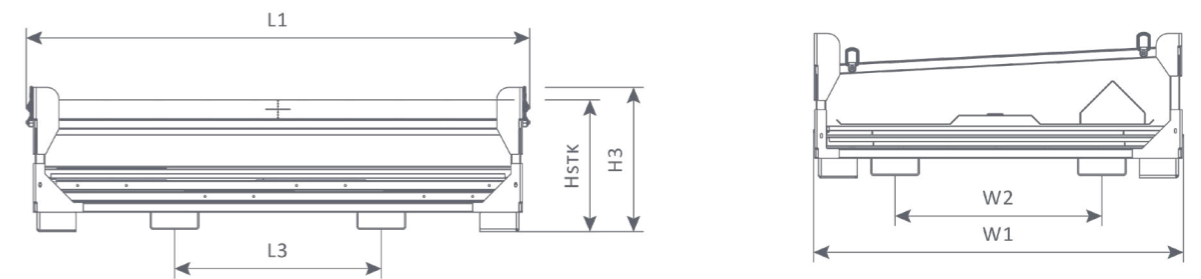

L1	L3	H3	W1	W2	HSTK
2070	850	595	1520	850	545

All dimensions are measured in mm.

PARTS DIAGRAM

PANELS

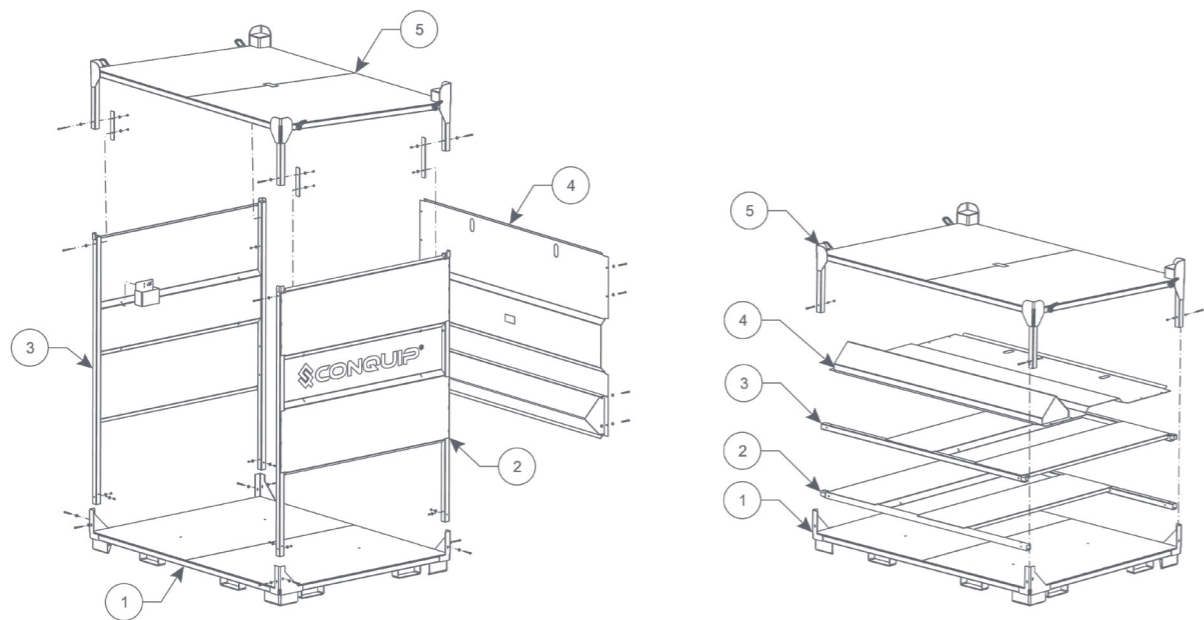

ITEM NUMBER	DESCRIPTION	QUANTITY
1	Base	1
2	Right Side Panel	1
3	Left Side Panel	1
4	Back Panel	1
5	Roof	1

NOTE: These parts are for this model, they may differ for previous versions. Please contact Conquip with any queries.

PARTS DIAGRAM

COMPONENTS

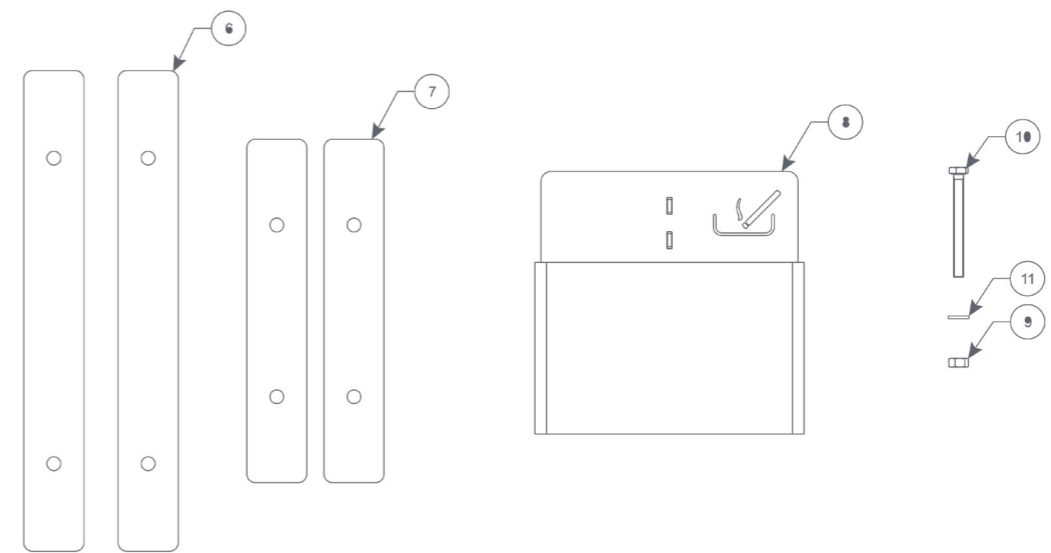

ITEM NUMBER	DESCRIPTION	QUANTITY
6	Rear Roof Joint Plate	2
7	Front Roof Joint Plate	2
8	Ashtray	1
9	Hex Nut M6x1	22
10	Hex Head Screw M6 x 1	22
11	Large Series Flat Washers M6	44

NOTE: These parts are for this model, they may differ for previous versions. Please contact Conquip with any queries.

GENERAL GUIDANCE

STORAGE

When not in use, the Smoking Shelter can be flat-packed to reduce the footprint of the unit. Where multiple units need to be stored, they can be stacked as shown in the images below.

Conquip recommend stacking a maximum of four units for safety and to prevent the possibility of the panels getting damaged.

MAXIMUM STACK - FOUR UNITS

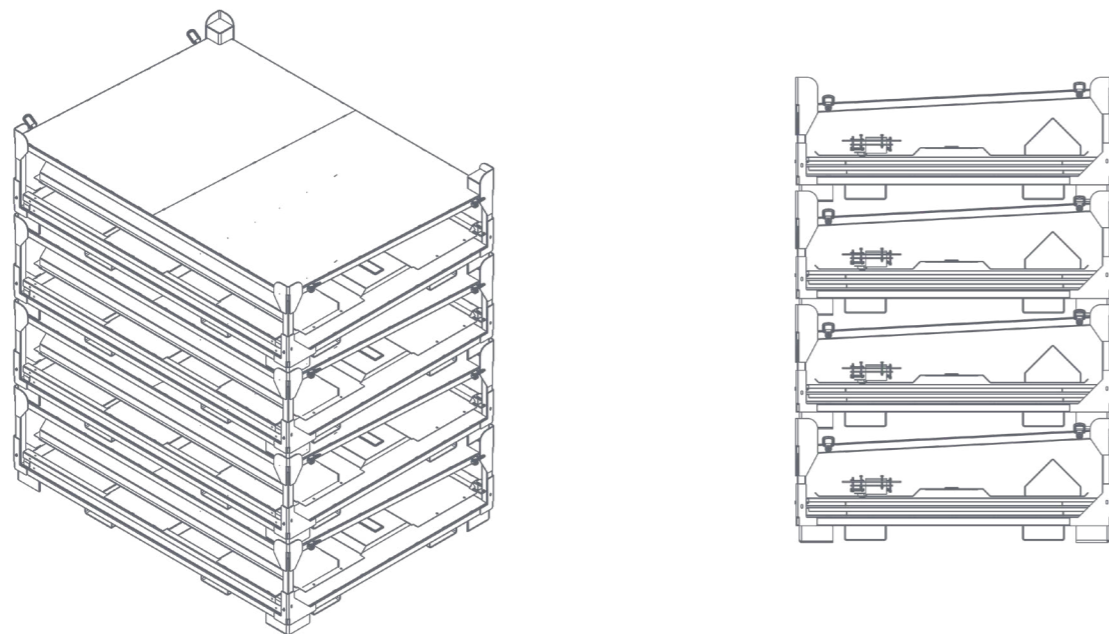

TRANSPORT & HANDLING

For transport, the right and left side panels are laid flat onto the base.

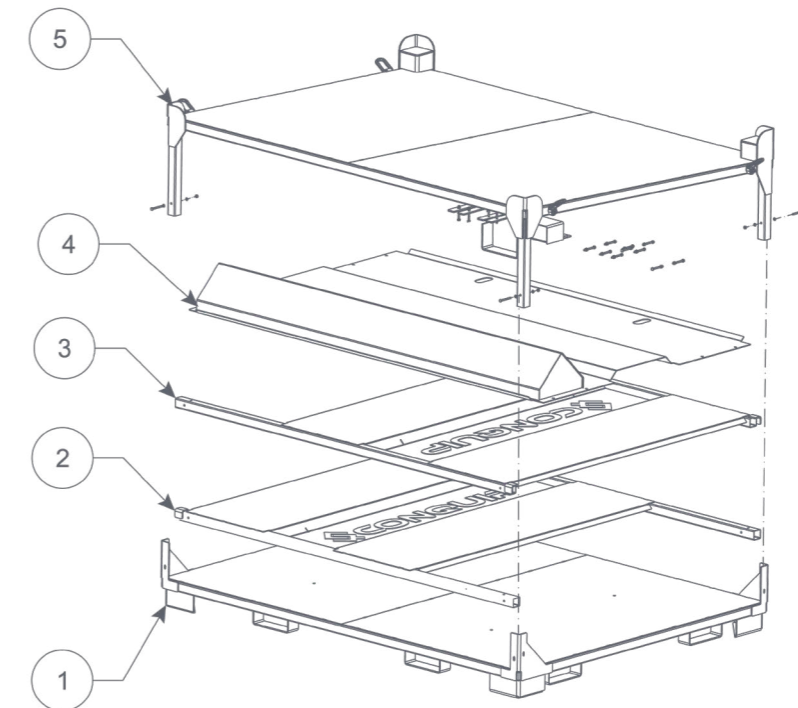

The roof is then bolted directly to the base using M6 hex head screws, washers and nuts.

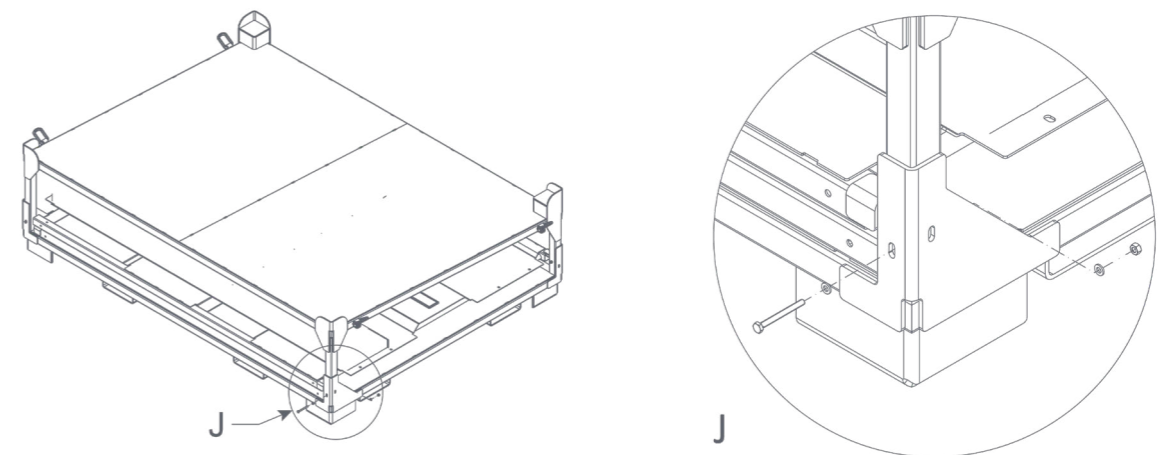

Do not stack more than four units and ensure they are appropriately secured.

OPERATIONAL PROCEDURES



IMPORTANT USAGE NOTES

- The Smoking Shelter must not be lifted with personnel inside.
- Set the unit up on a level surface, preferably a concreted area.
- If delivered to site flat-packed, follow the assembly instructions to build the unit.
- Use suitable lifting apparatus to manoeuvre the sections. Do not manhandle.

LIFTING WITH A FORKLIFT

01. To lift the Smoking Shelter with a forklift, set the machine's forks to the correct width for the fork pockets. Make sure that they are equidistant from the centre.
02. Drive the forklift to the Smoking Shelter, aligning the forks with the fork pockets.
03. Move the forklift forward until the forks are fully inserted into the fork pockets. The shelter is now ready to move.
04. Raise the Smoking Shelter just off the ground to check for balance and security.
05. Carefully transport the shelter to its required destination, taking care not to jolt the load.
06. When in position, lower the Smoking Shelter onto flat, firm and level ground.
07. Reverse the forklift back and clear of the unit.

LIFTING WITH A CRANE

01. Attach the crane, or other suitable lifting apparatus to the Smoking Shelter's four lifting points, using a certified four-leg lifting chain.
02. Ensure the hook's gate is correctly closed and the lifting eye is seated correctly in the hook.
03. Check that personnel are clear from the immediate area and the destination.
04. Allow for swing of the Smoking Shelter when lifting off the ground.
05. Raise the shelter just off the ground to check for balance and security.
06. Carefully transport the unit to its required destination.
07. When in position, lower the Smoking Shelter onto flat, firm and level ground.
08. Detach the lifting equipment from the Smoking Shelter.

ASSEMBLY INSTRUCTIONS

01. Using suitable lifting apparatus, attach lifting chains to the lifting points on the top of the right side panel and carefully move it into position above the base.



02. Lower the panel into the sockets on the base and secure in place using two M6 hex head screws, washers and nuts per socket.

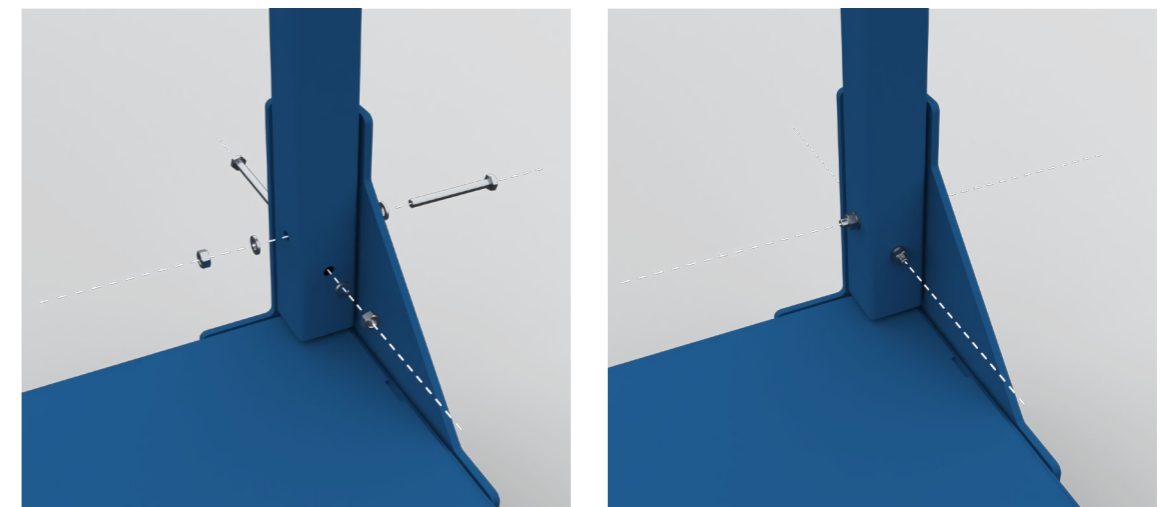

03. Repeat Steps 01 and 02 for the left side panel.

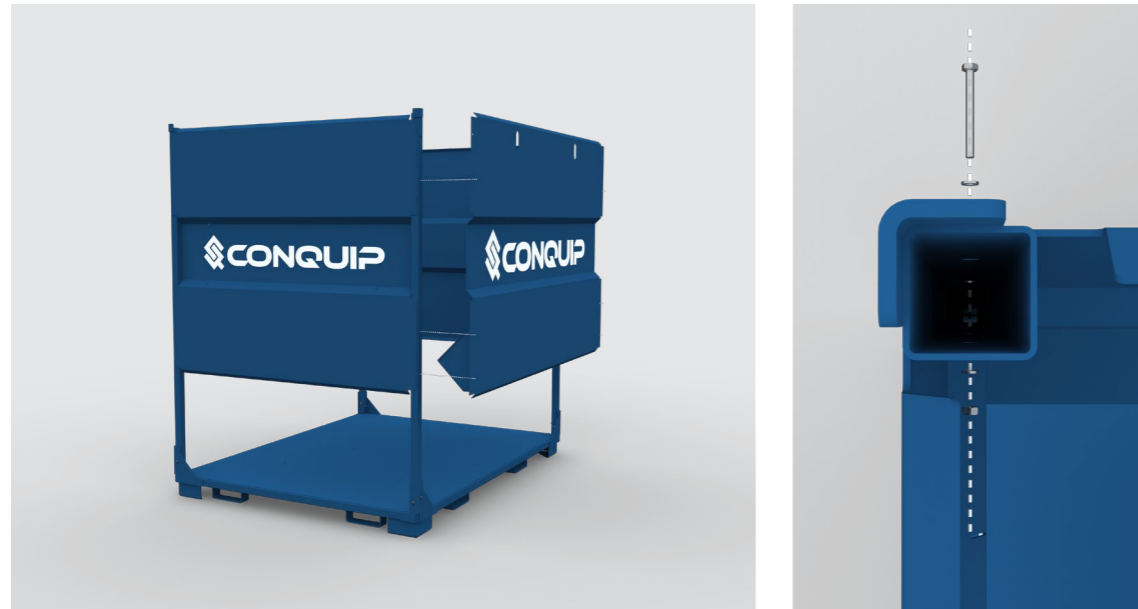

- 04. Attach lifting chains to the oval-shaped holes at the top of the back panel. Carefully lift the panel and move into position, lining up the top and bottom edges with the two side panels.
- 05. Once in position, secure the back panel to the side panels using the M6 hex head screws, washers and nuts. Only detach the lifting chains once the back panel has been secured.



- 06. Attach lifting chains to the lifting points of the roof. Carefully move into position above the frame and lower onto the four supports.

- 07. Secure the roof to the frame using the front and rear roof plates, M6 hex head screws, washers and nuts.

FRONT PLATES

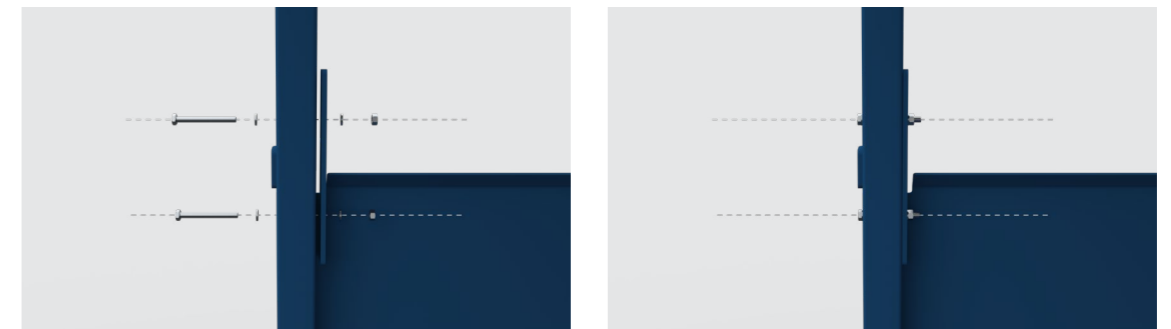

REAR PLATES



- 08. The ashtray simply slots in any of the four positions provided on the right or left hand side walls, depending on preference, and can be removed when it needs emptying.



- 09. The Smoking Shelter is now assembled and ready to use.

GENERAL SAFETY INSTRUCTIONS

The equipment should be properly operated and maintained to keep it in a safe, efficient operating condition. Be sure that all fixings and components are free of mud or other matter that might cause issues hazardous to the operator, serviceman, or other personnel or equipment. Report all malfunctions to those responsible for maintenance, and do not operate the equipment until corrected. Normal service or maintenance performed as required can prevent unexpected and unnecessary downtime.

This operations manual describes general inspections, servicing and operation with the normal safety precautions required for normal servicing and operating conditions. It is not a guide, however, for abnormal conditions or situations, and therefore, servicemen and operators must be safety conscious and alert to recognise potential servicing or operating safety hazards at all times, and take necessary precautions to assure safe servicing and operation of the machine.



M002
Refer to instructions manual



M004
Wear eye protection



M008
Wear safety footwear



M009
Wear protective gloves



M010
Wear protective clothing



M014
Wear head protection



M015
Wear high-visibility clothing

GENERAL NOTES

- Read this operations manual and learn the operating characteristics and limitations of the equipment. Know what operating clearances the machine requires.
- Read and understand all the safety signs prior to operation.
- If the safety signs are obstructed by dirt or debris, clean them using mild soap and water prior to operation.
- If the safety signs are damaged or illegible, replace them immediately, prior to operation.
- Be aware of operating hazards that weather changes can create on the job. Know proper procedures to follow when a severe rain or electrical storm strikes.
- Never attempt to operate or work on machinery when not feeling physically fit.
- Never wear loose clothing, rings, watches, heavy gloves etc., that might catch and result in injury.
- Know what safety equipment is required and use it. Such equipment may be: hard hat, safety glasses, reflector type vests, protective gloves and safety footwear.

TERMS & CONDITIONS

CONQUIP ENGINEERING GROUP STANDARD PRODUCT WARRANTY

01. COMMENCEMENT

1.1 This Warranty shall commence on the Commencement Date and shall continue until the earlier of:

- (a) the Expiry Date; or
- (b) the date on which it may be voided in accordance with clause 4.1(b)

when it shall terminate automatically without notice.

02. DUTY OF GOOD FAITH

2.1 The Purchaser shall in the exercise of its rights under this Warranty and in the compliance with its obligations under this Warranty be subject to and shall in all respects owe and comply with a duty of good faith to the Warrantor.

03. NATURE AND EXTENT OF COVER

3.1 Subject to clause 3.2 the Warrantor agrees and undertakes to the Purchaser that it shall be liable to the Purchaser under and in accordance with the terms of this Warranty in the event that:

- (a) prior to the Expiry Date the Purchaser shall notify a Warranty Claim to the Warrantor; and
- (b) the Equipment or any relevant part of the Equipment shall have become unusable as the result of defective material or defective workmanship prior to the Expiry Date.

3.2 The Warrantor's obligation under clause 3.1 shall be expressly subject to the provisions of clauses 4, 5 and 6 and conditional upon the Purchaser's compliance in full with the provisions of clause 7.

04. RESTRICTIONS

4.1 The following restrictions apply to this Warranty:

- (a) This Warranty is personal to the Purchaser and neither the legal benefit nor legal burden of this warranty may be assigned or novated or otherwise transferred by the

Purchaser to any other party. Any purported assignment, novation or transfer shall not be binding upon the Warrantor.

(b) This Warranty shall be void in the event that the Purchaser:

- (i) cannot provide authentic and original documentary evidence that the Purchaser has during the period between the Commencement Date and the Expiry Date complied with the Maintenance and Servicing Requirements; and/or
- (ii) has, during the period between the Commencement Date and the Expiry Date, exceeded the Purchaser's Usage Cycle Parameters; and/or
- (iii) has, during the period between the Commencement Date and the Expiry Date, exceeded the Purchaser's Use Parameters; and/or
- (iv) has carried out, or procured the carrying out by any third party of, any repair to the Equipment or any part of the Equipment which is not an Authorised Repair; and/or
- (v) has operated the Equipment after having replaced any part of the Equipment with a part which has not been supplied and fitted by the Warrantor; and/or
- (vi) has modified the Equipment in any way prior to use.

05. EXCLUSIONS

5.1 The following are excluded from the scope of this Warranty:

- (a) Loss of and/ or damage to the Equipment or any part of it resulting from any collision between the Equipment and any other fixed or stationary or mobile object whatsoever, irrespective of whether that collision was or was not caused by the Purchaser; and/or
- (b) Loss of and/or damage to any personal property and/or possessions or other equipment not forming part of the Equipment but which is present in or about the Equipment; and/or
- (c) loss and/or damage which is covered by any other insurance policy taken out and maintained by the Purchaser or in respect of which the Purchaser has a contractual obligation to do so; and/or
- (d) loss and/or damage to the equipment which is consistent with the use by the Purchaser of the Equipment:
 - (i) in compliance with the Maintenance and Servicing Requirements; and
 - (ii) in compliance with the Usage Cycle Parameters; and
 - (iii) in compliance with the Use Parameters; and
 - (iv) having only carried out Authorised Repairs to the Equipment; and
 - (v) having all and any replacement parts fitted by the Warrantor; and
 - (vi) in unmodified form.

06. LIMITATION OF LIABILITY

6.1 The Warrantor's liability to the Purchaser shall be limited as follows:

- (a) The Warrantor shall not in any circumstances be liable to the Purchaser for indirect and/or consequential and/or economic loss suffered and/or incurred as the case may be by the Purchaser; and
- (b) The Warrantor shall only be liable to the Purchaser for the reasonable and proper costs reasonably and properly incurred by the Purchaser directly in connection with the repair and/or replacement (at the Warrantor's absolute discretion) of the Equipment or any part of the Equipment; and
- (c) The Warrantor's liability to the Purchaser shall notwithstanding any other provision of this Warranty, not in any circumstances exceed the Purchase Price of the Equipment.

07. WARRANTY CLAIMS

7.1 The Purchaser shall in respect of any claim against the Warrantor under this Warranty and within 24 hours of the occurrence of the subject matter of the Warranty Claim:

- (a) Complete in full and submit to the Warrantor a Warranty Claim in the form annexed to Schedule 4;
- (b) Provide date stamped or date identifiable photographs evidencing the claim; and
- (c) Make the Equipment or the relevant part of the Equipment available to the Warrantor for inspection within 48 hours of notification of the relevant Warranty Claim.

08. ENTIRE AGREEMENT

8.1 This Warranty constitutes the entire agreement between the parties and supersedes and extinguishes all previous promises, assurances, warranties, representations and understandings between them, whether written or oral, relating to its subject matter.

8.2 Each party agrees that it shall have no remedies in respect of any statement, representation, assurance or warranty (whether made innocently or negligently) that is not set out in this Warranty. Each party agrees that it shall have no claim for innocent or negligent misrepresentation or negligent misstatement based on any statement in this Warranty.

No variation of this Warranty shall be effective unless it is in writing and signed by the parties (or their authorised representatives).

09. WAIVER

No failure or delay by a party to exercise any right or remedy provided under this Warranty or by law shall constitute a waiver of that or any other right or remedy, nor shall it prevent or restrict the further exercise of that or any other right or remedy. No single or partial exercise of such right or remedy shall prevent or restrict the further exercise of that or any other right or remedy.

10. SEVERANCE

10.1 If any provision or part-provision of this Warranty is or becomes invalid, illegal or unenforceable, it shall be deemed deleted, but that shall not affect the validity and enforceability of the rest of this Warranty.

10.2 If any provision or part-provision of this Warranty is deemed deleted under clause 10.1 the parties shall negotiate in good faith to agree a replacement provision that, to the greatest extent possible, achieves the intended commercial result of the original provision.

11. THIRD PARTY RIGHTS

11.1 This Warranty does not give rise to any rights under the Contracts (Rights of Third Parties) Act 1999 to enforce any term of this Warranty.

12. GOVERNING LAW

12.1 This Warranty and any dispute or claim (including non-contractual disputes or claims) arising out of or in connection with it or its subject matter or formation shall be governed by and construed in accordance with the law of England and Wales.

13. JURISDICTION

13.1 Each party irrevocably agrees that the courts of England and Wales shall have exclusive jurisdiction to settle any dispute or claim (including non-contractual disputes or claims) arising out of or in connection with this Warranty or its subject matter or formation.

EC DECLARATION OF CONFORMITY

IN ACCORDANCE WITH EN ISO 17050-1:2004

Declaration: As defined by the Machinery Directive 2006/42/EC and subsequent amendments

We, CONQUIP ENGINEERING GROUP, herewith declare that the following indicated equipment meets the fundamental health and safety requirements concerning the EU guideline(s), due to their design and manufacture.

This declaration will be rendered null and void if the machine is changed without our approval.

SIGNED:

DATED: 2024

Garry Critchley, Chief Executive Officer

PRODUCT CODE	GENERAL DESCRIPTION / DESIGNATION
SS901AD-07200	Smoking Shelter

ITEM	CODE	DESCRIPTION
EC DIRECTIVE/REGULATION	2006/42/EC	Directive 2006/42/EC- new machinery directive
HARMONISED STANDARDS	ISO 12100:2010	Safety of machinery General principles for design Risk assessment and risk reduction
	BS EN 1993-1-1: 2005	Eurocode 3. Design of steel structures General rules and rules for buildings
OTHER REGULATIONS	LOLER 1998	Lifting Operations and Lifting Equipment Regulations 1998 (LOLER)
	PUWER 1998	Provision and Use of Work Equipment Regulations 1998 (PUWER)

TALKING TO US IS EASY
WE'RE HERE TO HELP

Call us on (02) 8844 4590
Email us at sales@conquipgroup.com.au
www.cqegroup.com/au

